

DEORE Rear Disc Brake

**BR-M595** Brake Caliper  
**SM-RT62** Disc Rotor

**SM-BH59** Brake Hose

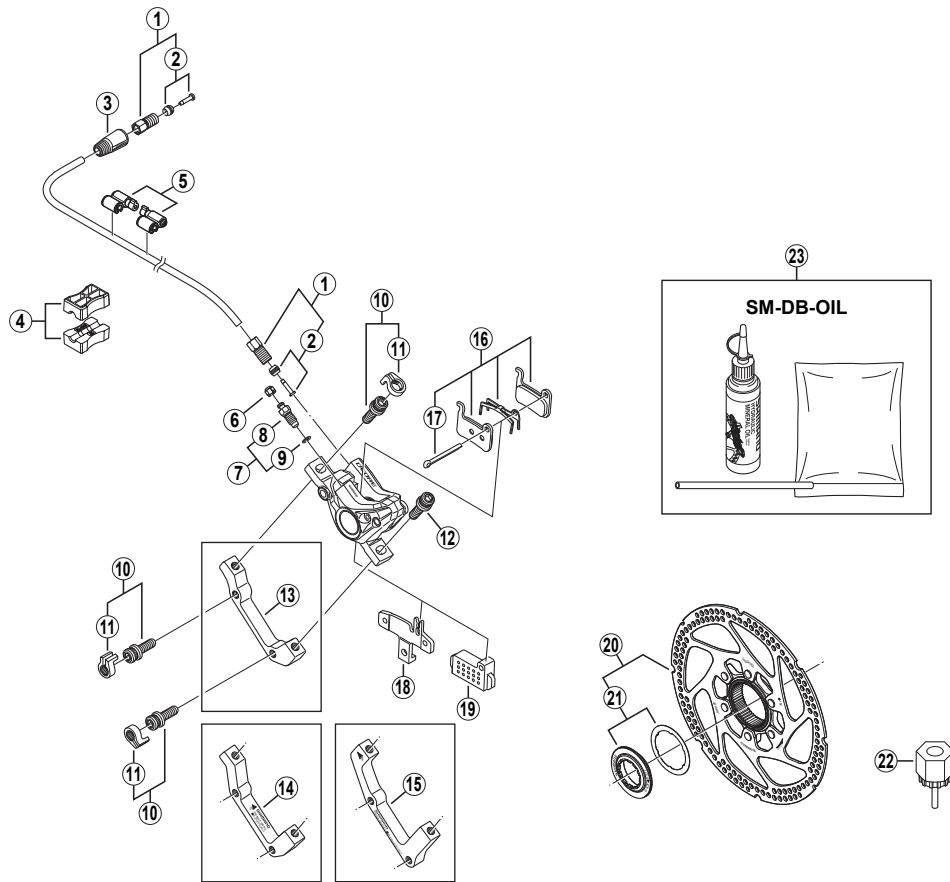

BR-M665  
BR-M585

ITEM NO.	SHIMANO CODE NO.	DESCRIPTION	INTERCHANGEABILITY	
			BR-M665	BR-M585
1	Y-8H2 98010	Connecting Bolt Unit	A	A
2	Y-8H2 98020	Olive & Connecting Insert	A	A
3	Y-8H2 03010	Cover	A	A
4	Y-8H1 98030	TL-BH61 Special Tool (2 pcs.)	A	A
5	Y-830 98040	SM-HANG Hose Supporter A & B	A	A
6	Y-8B2 14000	Bleed Nipple Cap	A	A
7	Y-8G4 98010	Bleed Nipple & Seal Ring		
8	Y-8CL 24100	Bleed Nipple		
9	Y-8B5 11001	O-Ring for Bleed Nipple	A	A
10	Y-8DS 98010	Adapter Fixing Bolt (M6 x 18.7) & Stop Ring	A	A
11	Y-8C5 11000	Stop Ring	A	A
12	Y-8C5 09020	Adapter Fixing Bolt (M6 x 18.7)	A	A
13	Y-8DB 10100	A-Standard Mount Adapter for Disc Rotor $\phi$ 160 mm	A	B
14	Y-817 71000	A-Standard Mount Adapter (SM-MA-R180P/S) for Disc Rotor $\phi$ 180 mm	A	A
15	Y-8CZ 01010	A-Standard Mount Adapter (SM-MA-R203P/S) for Disc Rotor $\phi$ 203 mm	A	
16	Y-8EP 98010	Resin Pad (A01S) & Spring w/Split Pin	A	B
	Y-8CL 98010	Metal Pad (M06) & Spring w/Split Pin	A	A
17	Y-8DB 06000	Split Pin	A	A
18	Y-8CL 12000	Pad Spacer	A	A
19	Y-8CL 18000	Spacer for Bleeding	A	A
20	E-SMRT62	SM-RT62 Disc Rotor Unit ( $\phi$ 160 mm)		A
	E-SMRT62M	SM-RT62M Disc Rotor Unit ( $\phi$ 180 mm)		A
	E-SMRT62L	SM-RT62L Disc Rotor Unit ( $\phi$ 203 mm)		
21	Y-8CL 98090	Lock Ring & Washer	A	
22	Y-120 09230	TL-LR15 Lock Ring Removal Tool	A	A
23	Y-839 98010	Mineral Oil Bleed Kit (50 ml)	A	A

A: Same parts.

B: Parts are usable, but differ in materials, appearance, finish, size, etc.

Absence of mark indicates non-interchangeability.

0903-2912

Specifications are subject to change without notice.

**SHIMANO**